

# Easypump® II ST/LT

## INSTRUCTIONS FOR HANDLING, STORAGE, PRIMING AND FILLING OF 5-FLUOROURACIL\*

5-Fluorouracil is a nucleoside metabolic inhibitor indicated for the treatment of patients with Adenocarcinoma of the Colon and Rectum, Adenocarcinoma of the Breast, Gastric Adenocarcinoma and Pancreatic Adenocarcinoma.<sup>1</sup> The drug is known to develop precipitate formation when stored incorrectly. Due to the known facts, this document was designed to clarify the key handling and storage information to help avoid precipitation.



### HANDLING & STORAGE OF 5-FLUOROURACIL in medication container and when stored in Easypump® II ST/LT



Store at room temperature /  
Do not store refrigerated or frozen



Protect from light



Do not use the vial for injection when  
particulate matter or aggregates are visible

### CAUTIONS

- Please store between +15 and +25° Celsius.  
Do not store refrigerated or frozen.
- Store medication container in box to protect the medication from light.
- In case the medication is stored at a temperature below +15° Celsius the medication might develop precipitate formation.

<sup>1</sup>accessdata.fda.gov

\*This brochure summarizes typical handling information on the drug. Always refer to drug manufacturer's package insert for drug reconstitution/dilution and storage procedures.

# PRIMING & FILLING INSTRUCTIONS FOR 5-FLUOROURACIL

## NOTE: STRICTLY USE STERILE AND ASEPTIC TECHNIQUE!

Elastomeric pumps can be filled with a Luer Lock syringe or a similar device. The tubing must be primed with approximately 10 ml of 0.9% sodium chloride solution before adding medication.

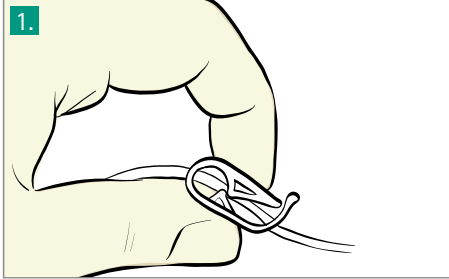

1. Close the clamp.



2. Flip open the comfort cap.

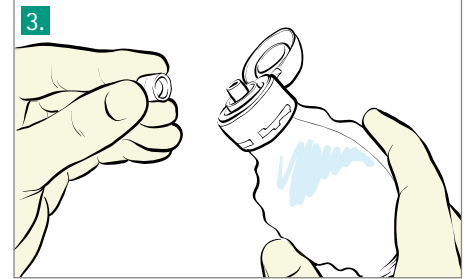

3. Twist off the closing cone from the filling port and place it on a sterile surface.



4. Attach the filling device to the filling port.



5. Initially fill Easypump® II with approximately 10 ml of diluent.

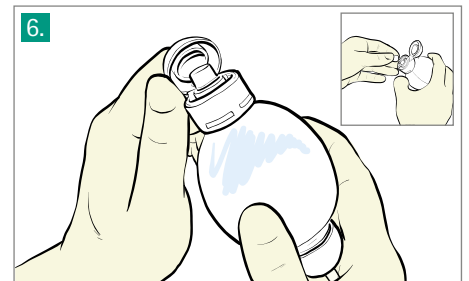

6. Remove the filling device from the filling port and close all caps.

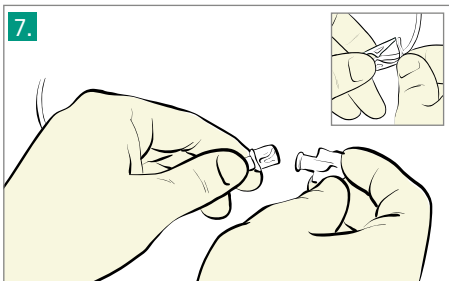

7. Open the closing cone of the patient connector. Release the clamp to prime the system.

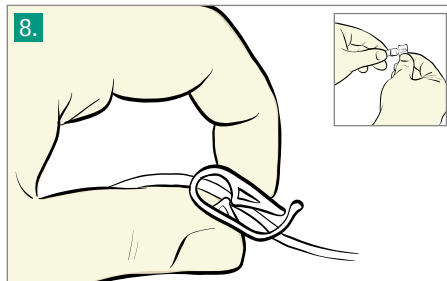

8. Close the clamp and reattach the closing cone of the patient connector. Do not re-open the clamp until the pump is connected to the patient.

### ADDING REMAINING DILUENT AND MEDICATION

Use aseptic technique: Repeat steps 2-5 until required volume is achieved.

Note: Please make sure, closing cones of filling port and patient connector are properly closed after filling and prior to use! At completion, the tubing will be filled exclusively with diluent, protecting from precipitation, while the pump reservoir will contain the medication until the infusion is started. This technique can be used for any drug prone to precipitation.



### PLEASE PAY ATTENTION

If not primed correctly, blockage or slow flow can occur due to crystallization in the area highlighted to the left during storage or infusion.